

A1

DO NOT SCALE

File: CP1770-BLP-ZZ-M2-MA-0040-0041-0042-00 Berth General Arrangement.dwg
Date: Jul 05, 2019 - 1:46pm Plotted by: TJOConnell

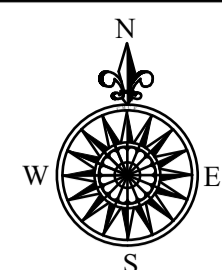
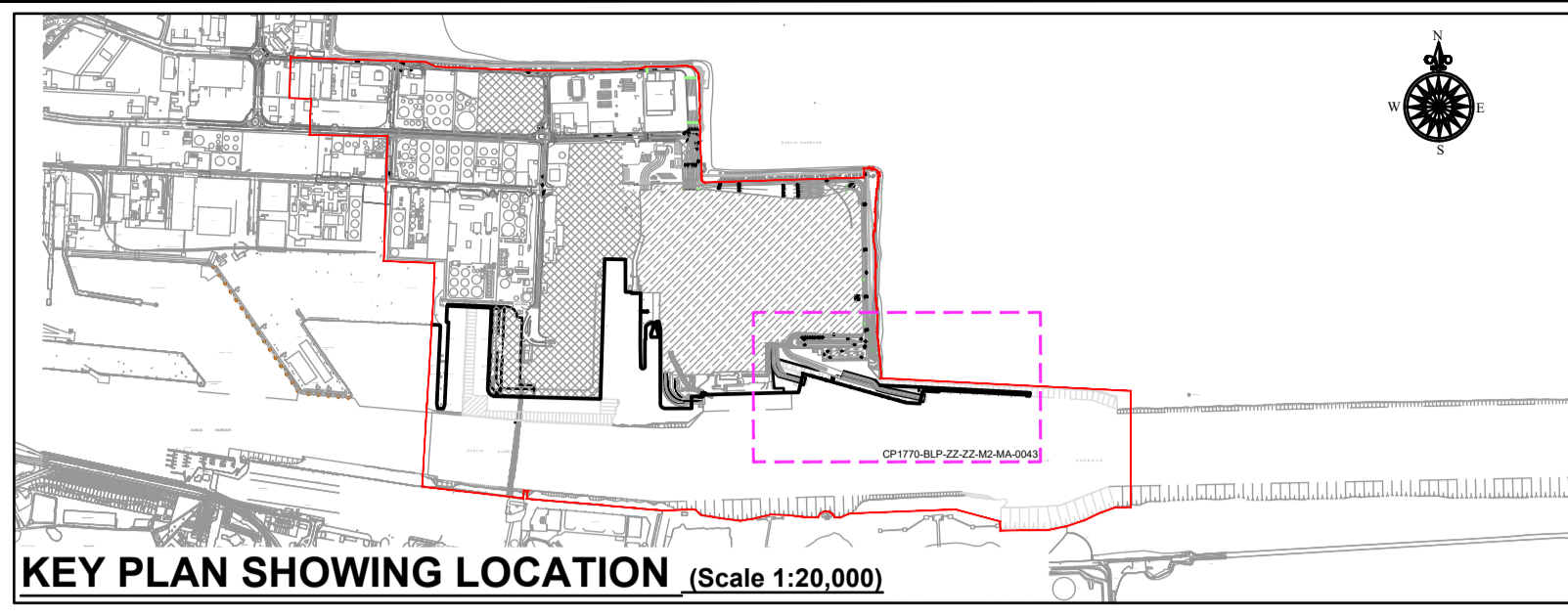

- GENERAL NOTES**
1. ALL DIMENSIONS ARE IN MILLIMETRES UNLESS NOTED OTHERWISE.
 2. ONLY WRITTEN DIMENSIONS SHALL BE USED. NO DIMENSIONS SHALL BE SCALED FROM THE DRAWINGS.
 3. ALL LEVELS ARE IN METRES AND ARE TO ORDNANCE DATUM MALIN UNLESS NOTED OTHERWISE.
 4. ALL COORDINATES ARE IN METRES AND ARE TO IRISH TRANSVERSE MERCATOR.
 5. DRAWINGS ARE TO BE READ IN CONJUNCTION WITH THE SPECIFICATION.
 6. ALL DRAWINGS ARE THE PROPERTY OF ATKINS BYRNELOOBY.
 7. [xx.xx m CD] REFER TO LEVELS AT CHART DATUM (DUBLIN PORT).
 8. ORDNANCE DATUM MALIN [O.D.M.].
- CHART DATUM [C.D.] (DUBLIN PORT) 2.51m
9. KEY PLAN LOCATION. [Dashed box]
 10. OS MAP SHEET NO:
3198-18, 3198-19, 3198-20, 3198-23, 3198-24, 3198-25, 3199-16, 3199-17, 3199-18, 3199-21, 3199-23, 3199-24, 3264-2, 3264-3, 3264-4, 3264-5, 3264-8, 3264-9, 3264-10, 3264-13, 3264-14, 3264-15, 3265-1, 3265-6, 3265-7, 3265-8, 3265-9, 3265-11, 3265-12.

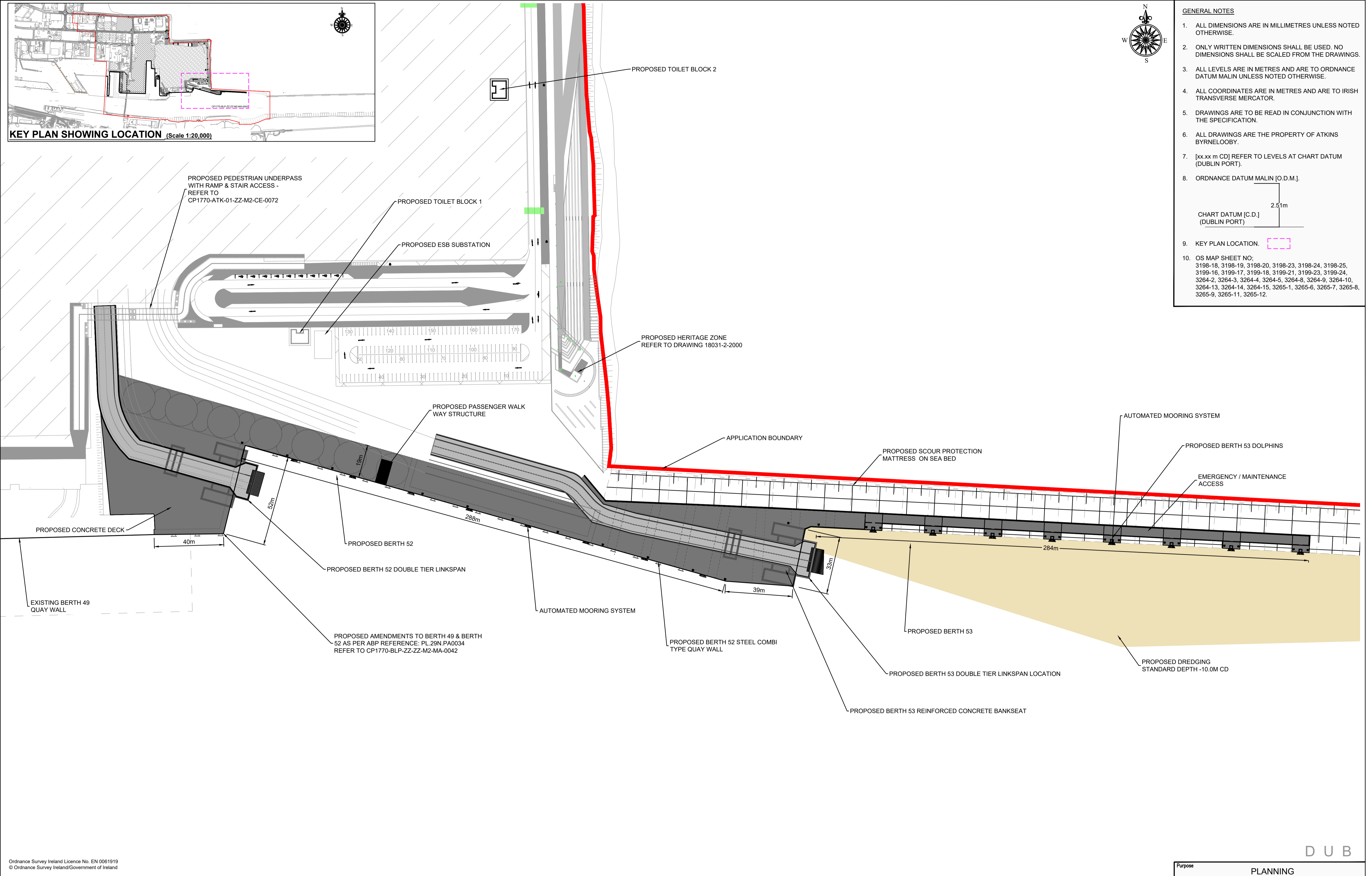

Ordnance Survey Ireland Licence No. EN 0061919
© Ordnance Survey Ireland/Government of Ireland

- APPLICATION BOUNDARY
- PROPOSED SCOUR PROTECTION MATTRESS ON SEA BED
- DREDGED SIDE SLOPES
- PROPOSED DREDGED AREA
- PROPOSED GANTRIES WITH VMS AND STATIC SIGNAGE
- PROPOSED 30m HIGHMAST LIGHTING
- PROPOSED 15m HIGHMAST LIGHTING
- PROPOSED STREET LIGHTING
- PROPOSED CONCRETE DECK
- EXISTING 30m HIGHMAST LIGHTING
- EXISTING LIGHTING
- EXISTING STREET LIGHTING
- CONTAINER FREIGHT TERMINAL YARD
- UNIFIED FERRY TERMINAL YARD

| Rev | Description | By | Date | Chk'd | Auth |
|-----|---------------------|------|-------|-------|------|
| 00 | ISSUED FOR PLANNING | TJOC | 07.19 | SMC | AC |

ATKINS
Member of the SNC-Lavalin Group

BYRNELOOBY
WS Atkins Ireland Ltd. & ByrneLooby Partners Ltd.
Atkins House,
150 Airside Business Park,
Swords, Co. Dublin

Client
COMHLACHT CHALAFOR
ÁTHA CLIATH
DUBLIN PORT COMPANY

Project
MP2

| | |
|--|---|
| Purpose PLANNING | |
| Title PROPOSED BERTH GENERAL ARRANGEMENTS SHEET 3 OF 3 | |
| Original Scale 1:1,000 @A1 | Design/Drawn TJOC |
| Date 28.09.18 | Checked SMC |
| Date 28.09.18 | Authorised AC |
| Date 28.09.18 | Rev 00 |
| Status P | Drawing Number CP1770-BLP-ZZ-M2-MA-0043 |

DUB